

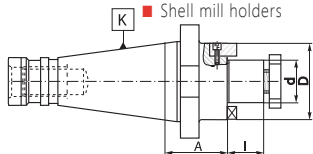

7311

- Messerkopfaufnahme zur Aufnahme von Fräsern nach DIN 138
- Shell mill holders



Artikel Nr. Code No.	K 7:24	d	A	I	D		
800001385	30	16	35	17	32	U-0620/0	S-2117/0
800001386	30	22	35	19	40	U-0621/0	S-2121/0
800001387	30	27	35	21	48	U-0622/0	S-2111/0
800001388	30	32	35	24	58	U-0623/0	S-2114/0
800001389	40	16	37	17	32	U-0620/0	S-2117/0
800001390	40	16	90	17	32	U-0620/0	S-2117/0
800001391	40	22	37	19	40	U-0621/0	S-2121/0
800001392	40	22	90	19	40	U-0621/0	S-2121/0
800001393	40	27	37	21	48	U-0622/0	S-2111/0
800001394	40	27	90	21	48	U-0622/0	S-2111/0
800001395	40	32	37	24	58	U-0623/0	S-2114/0
800001396	40	32	90	24	58	U-0623/0	S-2114/0
800001397	40	40	37	27	70	U-0624/0	S-2124/0
800001398	40	40	90	27	70	U-0624/0	S-2124/0
800001399	50	22	40	19	40	U-0621/0	S-2121/0
800001400	50	22	100	19	40	U-0621/0	S-2121/0
800001401	50	27	40	21	48	U-0622/0	S-2111/0
800001402	50	27	100	21	48	U-0622/0	S-2111/0
800001403	50	32	40	24	58	U-0623/0	S-2114/0
800001404	50	32	100	24	58	U-0623/0	S-2114/0
800001405	50	40	40	27	70	U-0624/0	S-2124/0
800001406	50	40	100	27	70	U-0624/0	S-2124/0
800001407	50	50	40	30	90	U-0625/0	U-5974/0
800001408	50	50	100	30	90	U-0625/0	U-5974/0



7311 QC

- Messerkopfaufnahme zur Aufnahme von Fräsern nach DIN 138
- Schnellwechselsystem
- Shell mill holders
- quick change version

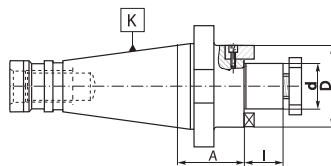

Artikel Nr. Code No.	K 7:24	d	A	I	D		
800001409	30	16	45	17	32	U-0620/0	S-2117/0
800001410	30	22	45	19	40	U-0621/0	S-2121/0
800001411	30	27	45	21	48	U-0622/0	S-2111/0
800001412	30	32	45	24	58	U-0623/0	S-2114/0
800001413	40	16	50	17	32	U-0620/0	S-2117/0
800001414	40	16	90	17	32	U-0620/0	S-2117/0
800001415	40	22	50	19	40	U-0621/0	S-2121/0
800001416	40	22	90	19	40	U-0621/0	S-2121/0
800001417	40	27	50	21	48	U-0622/0	S-2111/0
800001418	40	27	90	21	48	U-0622/0	S-2111/0
800001419	40	32	50	24	58	U-0623/0	S-2114/0
800001420	40	32	90	24	58	U-0623/0	S-2114/0
800001421	40	40	50	27	70	U-0624/0	S-2124/0
800001422	40	40	90	27	70	U-0624/0	S-2124/0



7314

- Sägeblattaufnahme
- Milling arbors for disc milling cutters

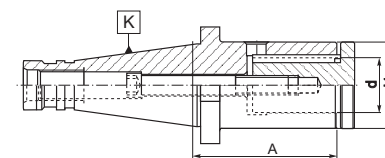

Artikel Nr. Code No.	K 7:24	d	d ₁	A			
800001423	40	16	29	70	U-6520/0	U-6510/0	U-6526/0
800001424	40	16	29	100	U-6520/0	U-6511/0	U-6527/0
800001425	40	22	36	70	U-6523/0	U-6512/0	U-6528/0
800001426	40	22	36	100	U-6523/0	U-6513/0	U-6529/0
800001427	40	27	42	70	U-6523/0	U-6514/0	U-6530/0
800001428	40	27	42	100	U-6523/0	U-6515/0	U-6531/0
800001429	40	32	50	70	U-6523/0	U-6516/0	U-6532/0
800001430	40	32	50	100	U-6523/0	U-6517/0	U-6533/0
800001431	40	40	58	70	U-6523/0	U-6518/0	U-6534/0
800001432	40	40	58	100	U-6523/0	U-6519/0	U-6535/0
800001433	50	27	42	75	U-6524/0	U-6514/0	U-6530/0
800001434	50	27	42	105	U-6524/0	U-6515/0	U-6531/0
800001435	50	32	50	75	U-6524/0	U-6516/0	U-6532/0
800001436	50	32	50	105	U-6524/0	U-6517/0	U-6533/0
800001437	50	40	58	75	U-6524/0	U-6518/0	U-6534/0
800001438	50	40	58	105	U-6524/0	U-6519/0	U-6535/0

Artikel Nr. Code No.	K 7:24	d	A	I	D			
800001439	30	16	35	17	32	U-0620/0	U-1364/0	U-1355/0
800001440	30	16	50	17	32	U-0620/0	U-1364/0	U-1355/0
800001441	30	16	73	17	32	U-0620/0	U-1364/0	U-1355/0
800001442	30	22	35	19	40	U-0621/0	U-1365/0	U-1356/0
800001443	30	22	50	19	40	U-0621/0	U-1365/0	U-1356/0
800001444	30	22	73	19	40	U-0621/0	U-1365/0	U-1356/0
800001445	30	27	35	21	48	U-0622/0	U-1366/0	U-1357/0
800001446	30	27	50	21	48	U-0622/0	U-1366/0	U-1357/0
800001447	30	27	73	21	48	U-0622/0	U-1366/0	U-1357/0
800001448	30	32	50	24	58	U-0623/0	U-1367/0	U-1358/0
800001449	40	16	37	17	32	U-0620/0	U-1364/0	U-1355/0
800001450	40	16	52	17	32	U-0620/0	U-1364/0	U-1355/0
800001451	40	16	75	17	32	U-0620/0	U-1364/0	U-1355/0
800001452	40	22	37	19	40	U-0621/0	U-1365/0	U-1356/0
800001453	40	22	52	19	40	U-0621/0	U-1365/0	U-1356/0
800001454	40	22	75	19	40	U-0621/0	U-1365/0	U-1356/0
800001455	40	27	37	21	48	U-0622/0	U-1366/0	U-1357/0
800001456	40	27	52	21	48	U-0622/0	U-1366/0	U-1357/0

Artikel Nr. Code No.	K 7:24	d	A	I	D			
800001457	40	27	75	21	48	U-0622/0	U-1366/0	U-1357/0
800001458	40	32	41	24	58	U-0623/0	U-1367/0	U-1358/0
800001459	40	32	52	24	58	U-0623/0	U-1367/0	U-1358/0
800001460	40	32	75	24	58	U-0623/0	U-1367/0	U-1358/0
800001461	40	40	45	27	70	U-0624/0	U-1368/0	U-1359/0
800001462	40	40	52	27	70	U-0624/0	U-1368/0	U-1359/0
800001463	40	40	75	27	70	U-0624/0	U-1368/0	U-1359/0
800001464	50	16	55	17	32	U-0620/0	U-1364/0	U-1355/0
800001465	50	16	78	17	32	U-0620/0	U-1364/0	U-1355/0
800001466	50	22	55	19	40	U-0621/0	U-1365/0	U-1356/0
800001467	50	22	78	19	40	U-0621/0	U-1365/0	U-1356/0
800001468	50	27	55	21	48	U-0622/0	U-1366/0	U-1357/0
800001469	50	27	78	21	48	U-0622/0	U-1366/0	U-1357/0
800001470	50	32	55	24	58	U-0623/0	U-1367/0	U-1358/0
800001471	50	32	78	24	58	U-0623/0	U-1367/0	U-1358/0
800001472	50	40	55	27	70	U-0624/0	U-1368/0	U-1359/0
800001473	50	40	78	27	70	U-0624/0	U-1368/0	U-1359/0
800001474	50	50	55	30	90	U-0625/0	U-1369/0	U-1360/0
800001475	50	50	78	30	90	U-0625/0	U-1369/0	U-1360/0

7332

- Kombi-Aufsteckfräsdorn zur Aufnahme von Fräsern mit Längs- und Quernut nach DIN 138
- Combination shell mill holders

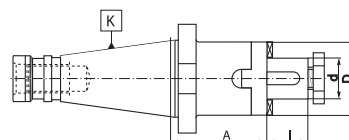

7332 QC

- Kombi-Aufsteckfräsdorn zur Aufnahme von Fräsern mit Längs- und Quernut nach DIN 138 - Schnellwechselsystem
- Combination shell mill holders
- quick change version

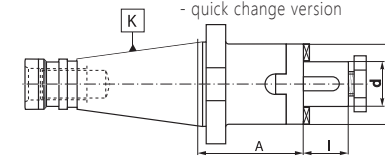

Artikel Nr. Code No.	K 7:24	d	A	I	D			
800001476	30	16	52	17	32	U-0620/0	U-1364/0	U-1355/0
800001477	30	22	52	19	40	U-0621/0	U-1365/0	U-1356/0
800001478	30	27	54	21	48	U-0622/0	U-1366/0	U-1357/0
800001479	30	32	58	24	58	U-0623/0	U-1367/0	U-1358/0
800001480	40	16	52	17	32	U-0620/0	U-1364/0	U-1355/0
800001481	40	22	52	19	40	U-0621/0	U-1365/0	U-1356/0
800001482	40	27	54	21	48	U-0622/0	U-1366/0	U-1357/0
800001483	40	32	58	24	58	U-0623/0	U-1367/0	U-1358/0
800001484	40	40	60	27	70	U-0624/0	U-1368/0	U-1359/0